

# The DuraBoxx® Series

D

The Stahlin DuraBoxx® Series was developed with a sleek design and shallow depths. These enclosures are suited for rugged, durable performance in both commercial and industrial indoor and outdoor environments such as mining, oil, gas, wastewater treatment, and petro-chem. Also, because of their pleasing aesthetics and flush cover design, they are well suited for high-end electronic applications such as wireless communications and operator interfaces.

## DuraBoxx® Series Attributes

- 14 sizes available
- Size range from 3" x 3" to 24" x 16"
- Flat cover with captive cover screws
- DIN rail mounting capabilities
- No sidewall obstructions, flush cover
- Clear cover options available on select sizes
- Back panels available for all sizes

## DuraBoxx® Industry Standards

|                            |  |
|----------------------------|--|
| <b>UL/cUL 50/508</b>       | File E64358 Type 1, 3, 3S, 4X, 6, 6P, 12   |
| <b>NEMA 250</b>            | Type 1, 3, 3S, 4X, 6, 6P, 12               |
| <b>CSA Std C22.2</b>       | File LR069014 Type 1, 3, 3S, 4X, 6, 6P, 12 |
| <b>IEC 529</b>             | IP66, IP67, IP68                           |
| <b>Temperature Range</b>   | (-26°F to +257°F) (-32°C to +125°C)        |
| <b>Flammability Rating</b> | UL94-V0                                    |
| <b>Self Extinguishing</b>  | Non-halogenated, Non-flame propagating     |



DuraBoxx®



# Technical Specifications - D Series

D

*"W" configuration - Flush fitting cover fastened by captive lid screws.*



## W Construction

|                                 |  |
|---------------------------------|--|
| <b>Material</b>                 | Hot compression molded fiberglass reinforced polyester (thermoset)                         |
| <b>Gasket</b>                   | Poured polyurethane seamless gasket provides watertight, dust-tight environmental seal     |
| <b>Recessed Screws</b>          | No protruding surfaces   |
| <b>Stainless Steel Hardware</b> | 300 Series stainless used on all hardware  |
| <b>Mounting Bosses</b>          | Panel mounting capability for fixed rear panel   |
| <b>Metal inserts</b>            | All bosses utilize threaded brass inserts accepting 10-32 screws                           |
| <b>Soft Edge Design</b>         | Rounded edges, minimal protrusions or exposed pocket areas for assembly of dust and debris |

## W Industry Standards

|                            |  |
|----------------------------|--|
| <b>UL/cUL 50/508</b>       | File E64358 Type 1, 3, 3S, 4X, 6, 6P, 12   |
| <b>NEMA 250</b>            | Type 1, 3, 3S, 4X, 6, 6P, 12               |
| <b>CSA Std C22.2</b>       | File LR069014 Type 1, 3, 3S, 4X, 6, 6P, 12 |
| <b>IEC 529</b>             | IP66, IP67, IP68                           |
| <b>Temperature Range</b>   | (-26°F to +257°F) (-32°C to +125°C)        |
| <b>Flammability Rating</b> | UL94-V0                                    |
| <b>Self Extinguishing</b>  | Non-halogenated, Non-flame propagating     |

**NOTES:**

## W Accessories

### Back Panels

|                     |       |         |
|---------------------|-------|---------|
| <b>Carbon Steel</b> | BP_CS | pg. 153 |
|---------------------|-------|---------|

### Accessories

|                                     |               |
|-------------------------------------|---------------|
| <b>Drain &amp; Breather Vents</b>   | pg. 144, 146  |
| <b>Hole Plugs</b>                   | pg. 145       |
| <b>Assorted Hubs and Cord Grips</b> | pg. 145, 148  |
| <b>All Other Accessories</b>        | pg. 144 - 159 |

## W Modifications

|                             |             |
|-----------------------------|-------------|
| <b>Custom Colors</b>        | pg. 12 - 13 |
| <b>Silk Screening</b>       | pg. 12 - 13 |
| <b>EMI/RFI Shielding</b>    | pg. 12 - 13 |
| <b>Custom Window</b>        | pg. 12 - 13 |
| <b>Custom Cutouts/Holes</b> | pg. 12 - 13 |

DuraBoxx®

D Series "W" Configuration Technical Drawings

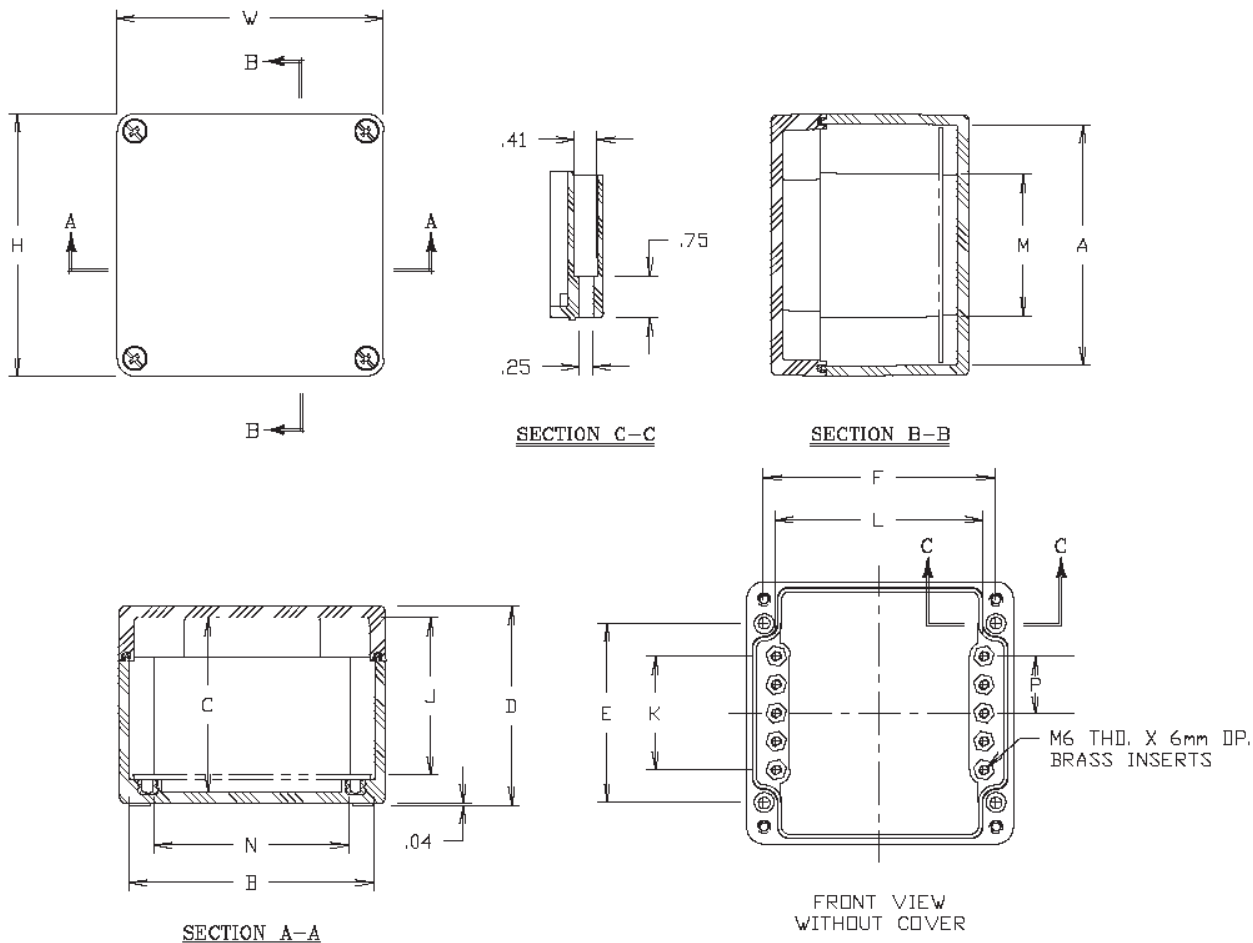

| DuraBoxx® D Series Enclosures |   |   |                              |               |               |                |                |                |               |                 |           |
|-------------------------------|---|---|------------------------------|---------------|---------------|----------------|----------------|----------------|---------------|-----------------|-----------|
| SIZE ID NUMBER                | OVERALL H X W X D                         | INSIDE A X B X C                          | MOUNTING E X F               | J             | K             | L              | M              | N              | P             | SHIPPING WEIGHT | PANEL NO. |
| D333W                         | 2.95 x 3.15 x 2.78<br>(75 x 80 x 76)      | 2.56 x 2.76 x 2.56<br>(65 x 70 x 65)      | 1.57 x 2.48<br>(40 x 63)     | 2.26<br>(57)  | N/A           | 2.28<br>(58)   | 1.06<br>(27)   | 1.93<br>(49)   | N/A           | 0.81 LB         | D333BP*   |
| D342W                         | 2.95 x 4.33 x 2.22<br>(75 x 110 x 56)     | 2.56 x 3.93 x 1.81<br>(65 x 100 x 46)     | 1.77 x 3.86<br>(45 x 98)     | 1.53<br>(39)  | N/A           | 3.50<br>(89)   | 1.29<br>(33)   | 3.37<br>(86)   | N/A           | .88 LB          | D342BP*   |
| D554W<br>DCC554W              | 4.72 x 4.80 x 3.58<br>(120 x 122 x 91)    | 4.33 x 4.41 x 3.15<br>(110 x 112 x 80)    | 3.23 x 4.17<br>(82 x 106)    | 2.93<br>(74)  | 2.05<br>(52)  | 3.74<br>(95)   | 2.56<br>(65)   | 3.50<br>(89)   | 1.02<br>(26)  | 1.7 LB          | D554BP*   |
| D593W<br>DCC593W              | 4.72 x 8.66 x 3.19<br>(120 x 220 x 81)    | 4.34 x 8.28 x 2.83<br>(110 x 210 x 72)    | 3.23 x 8.03<br>(82 x 204)    | 2.62<br>(67)  | 2.05<br>(52)  | 7.60<br>(193)  | 2.57<br>(65)   | 7.37<br>(187)  | 1.02<br>(26)  | 2.4 LB          | D000BP*   |
| D594W<br>DCC594W              | 4.72 x 8.66 x 3.58<br>(120 x 220 x 91)    | 4.33 x 8.27 x 3.15<br>(110 x 210 x 80)    | 3.23 x 8.03<br>(82 x 204)    | 2.93<br>(74)  | 2.05<br>(52)  | 7.60<br>(193)  | 2.57<br>(65)   | 7.37<br>(187)  | 1.02<br>(26)  | 2.5 LB          | D594BP*   |
| D774W                         | 6.30 x 6.30 x 3.58<br>(160 x 160 x 91)    | 5.79 x 5.79 x 3.11<br>(147 x 147 x 79)    | 4.33 x 5.51<br>(110 x 140)   | 2.93<br>(74)  | 2.99<br>(76)  | 5.20<br>(132)  | 3.50<br>(89)   | 4.68<br>(119)  | 1.50<br>(38)  | 2.8 LB          | D774BP*   |
| D7114W                        | 6.30 x 10.24 x 3.58<br>(160 x 260 x 91)   | 5.79 x 9.72 x 3.11<br>(147 x 247 x 79)    | 4.33 x 9.45<br>(110 x 240)   | 2.93<br>(74)  | 2.99<br>(76)  | 9.13<br>(232)  | 3.50<br>(89)   | 8.62<br>(219)  | 1.50<br>(38)  | 3.8 LB          | D7114BP*  |
| D10105W                       | 9.84 x 10.04 x 4.76<br>(250 x 255 x 121)  | 9.31 x 9.51 x 4.29<br>(236 x 242 x 109)   | 7.87 x 9.25<br>(200 x 235)   | 4.11<br>(104) | 3.94<br>(100) | 8.94<br>(227)  | 7.03<br>(179)  | 8.41<br>(214)  | 1.97<br>(50)  | 6.4 LB          | D10105BP* |
| D10165W                       | 9.84 x 15.75 x 4.76<br>(250 x 400 x 121)  | 9.31 x 15.22 x 4.29<br>(236 x 387 x 109)  | 7.87 x 14.96<br>(200 x 380)  | 4.09<br>(104) | 3.94<br>(100) | 14.65<br>(327) | 7.03<br>(179)  | 14.12<br>(359) | 1.97<br>(50)  | 8.8 LB          | D10165BP* |
| D14144W                       | 14.17 x 14.17 x 3.58<br>(360 x 360 x 91)  | 13.66 x 13.66 x 3.11<br>(347 x 347 x 79)  | 12.20 x 13.39<br>(310 x 340) | 2.91<br>(74)  | 5.35<br>(136) | 13.07<br>(332) | 11.38<br>(289) | 12.56<br>(319) | 2.68<br>(68)  | 8.0 LB          | D14144BP* |
| D16165W                       | 15.94 x 15.75 x 4.76<br>(405 x 400 x 121) | 15.42 x 15.22 x 4.29<br>(392 x 387 x 109) | 13.98 x 14.96<br>(355 x 380) | 4.09<br>(104) | 9.84<br>(250) | 14.65<br>(372) | 13.14<br>(334) | 14.12<br>(359) | 4.92<br>(125) | 11.0 LB         | D16165BP* |

Duraboxx® Clear Cover Sizes: DCC Part Number

\* Panel ordered separately



# Technical Specifications - DL Series

DL

*“W” configuration - Flush fitting cover fastened by captive lid screws.*



## W Construction

|                                 |  |
|---------------------------------|--|
| <b>Material</b>                 | Hot compression molded fiberglass reinforced polyester (thermoset)                         |
| <b>Gasket</b>                   | Poured polyurethane seamless gasket provides watertight, dust-tight environmental seal     |
| <b>Recessed Screws</b>          | No protruding surfaces   |
| <b>Stainless Steel Hardware</b> | 300 Series stainless used on all hardware  |
| <b>Mounting Bosses</b>          | Panel mounting capability for fixed rear panel   |
| <b>Metal inserts</b>            | All bosses utilize threaded brass inserts accepting 10-32 screws                           |
| <b>Soft Edge Design</b>         | Rounded edges, minimal protrusions or exposed pocket areas for assembly of dust and debris |

## W Industry Standards

|                            |  |
|----------------------------|--|
| <b>UL/cUL 50/508</b>       | File E64358 Type 1, 3, 3S, 4X, 6, 6P, 12   |
| <b>NEMA 250</b>            | Type 1, 3, 3S, 4X, 6, 6P, 12               |
| <b>CSA Std C22.2</b>       | File LR069014 Type 1, 3, 3S, 4X, 6, 6P, 12 |
| <b>IEC 529</b>             | IP66, IP67, IP68                           |
| <b>Temperature Range</b>   | (-26°F to +257°F) (-32°C to +125°C)        |
| <b>Flammability Rating</b> | UL94-V0                                    |
| <b>Self Extinguishing</b>  | Non-halogenated, Non-flame propagating     |

**NOTES:**

## W Accessories

### Back Panels

|                     |       |         |
|---------------------|-------|---------|
| <b>Carbon Steel</b> | BP_CS | pg. 153 |
|---------------------|-------|---------|

### Accessories

|                                     |               |
|-------------------------------------|---------------|
| <b>Drain &amp; Breather Vents</b>   | pg. 144, 146  |
| <b>Hole Plugs</b>                   | pg. 145       |
| <b>Assorted Hubs and Cord Grips</b> | pg. 145, 148  |
| <b>All Other Accessories</b>        | pg. 144 - 159 |

## W Modifications

|                             |             |
|-----------------------------|-------------|
| <b>Custom Colors</b>        | pg. 12 - 13 |
| <b>Silk Screening</b>       | pg. 12 - 13 |
| <b>EMI/RFI Shielding</b>    | pg. 12 - 13 |
| <b>Custom Window</b>        | pg. 12 - 13 |
| <b>Custom Cutouts/Holes</b> | pg. 12 - 13 |

DuraBoxx®



DL Series "W" Configuration Technical Drawings

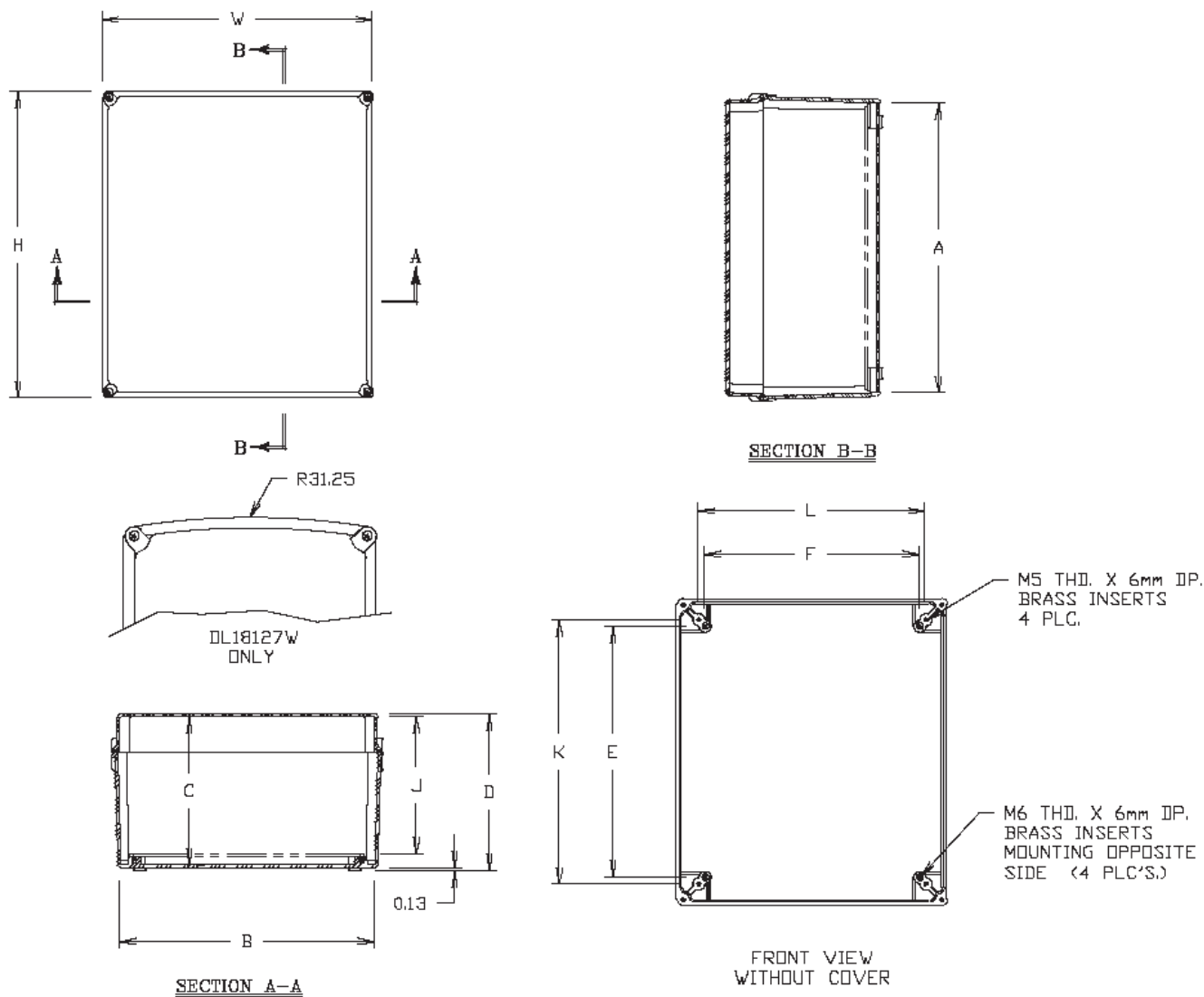

| DuraBoxx® DL Series Enclosures |   |   |                              |               |                |                |                 |            |
|--------------------------------|---|---|------------------------------|---------------|----------------|----------------|-----------------|------------|
| SIZE ID NUMBER                 | OVERALL H X W X D                         | INSIDE A X B X C                          | MOUNTING E X F               | J             | K              | L              | SHIPPING WEIGHT | PANEL NO.  |
| DL18127W                       | 16.54 x 10.63 x 7.22<br>(420 x 270 x 183) | 15.02 x 9.12 x 6.85<br>(382 x 232 x 174)  | 12.68 x 7.17<br>(322 x 182)  | 6.26<br>(159) | 13.46<br>(342) | 7.95<br>(202)  | 5.5 LBS         | DL18127BP* |
| DL18168W                       | 16.54 x 14.57 x 8.44<br>(420 x 370 x 214) | 15.56 x 13.59 x 7.99<br>(395 x 345 x 207) | 13.54 x 11.57<br>(344 x 294) | 7.44<br>(189) | 14.25<br>(362) | 12.24<br>(311) | 9.9 LBS         | DL18168BP* |
| DL24168W                       | 23.63 x 16.54 x 8.44<br>(600 x 420 x 214) | 22.67 x 15.55 x 7.99<br>(576 x 395 x 207) | 20.63 x 13.54<br>(524 x 344) | 7.44<br>(189) | 21.34<br>(542) | 14.21<br>(361) | 15.4 LBS        | DL24168BP* |

Caution: Metric units are for reference; do not convert  
 \* Panel ordered separately